



mere™ 5-slider

your lighting rep has
recommended the **mere™**
pendant for your project
Let's take a quick look:



sizes and lumens

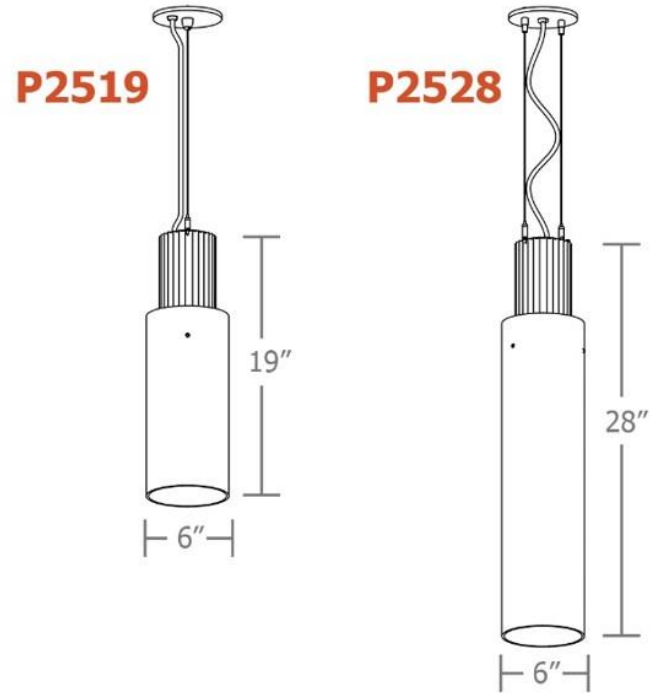

- P2519 (19") / 1535 – 3790 lm
- P2528 (28") / 1535 – 3790 lm



construction

integral programmable constant current ,
universal input (120-277v) driver, field
maintainable, 0-10v controllable to 1% dimming.

single COB LED module **90+ CRI** standard
2700K, 3000K, 3500K and 4000K.

6" dia. cylindrical open bottom
P95 white acrylic diffuser

optional P95 acrylic bottom lens,
solvent welded to bottom of
cylindrical diffuser



5" dia. spun steel canopy with single or
dual field adjustable stainless-steel cables

2 anodized finishes + 12 standard
powder coat paint finishes + custom
RAL colors

(POC) power over cable suspension
system option provides a clean look
without the need for a separate power
cord

optional color cloth power cord in
blue, orange, purple, red, or white
& gray dot

performance

| Statistics | | | | | | |
|-------------|--------|---------|---------|---------|---------|---------|
| Description | Symbol | Avg | Max | Min | Max/Min | Avg/Min |
| mere | + | 18.4 fc | 32.1 fc | 11.2 fc | 2.9:1 | 1.6:1 |

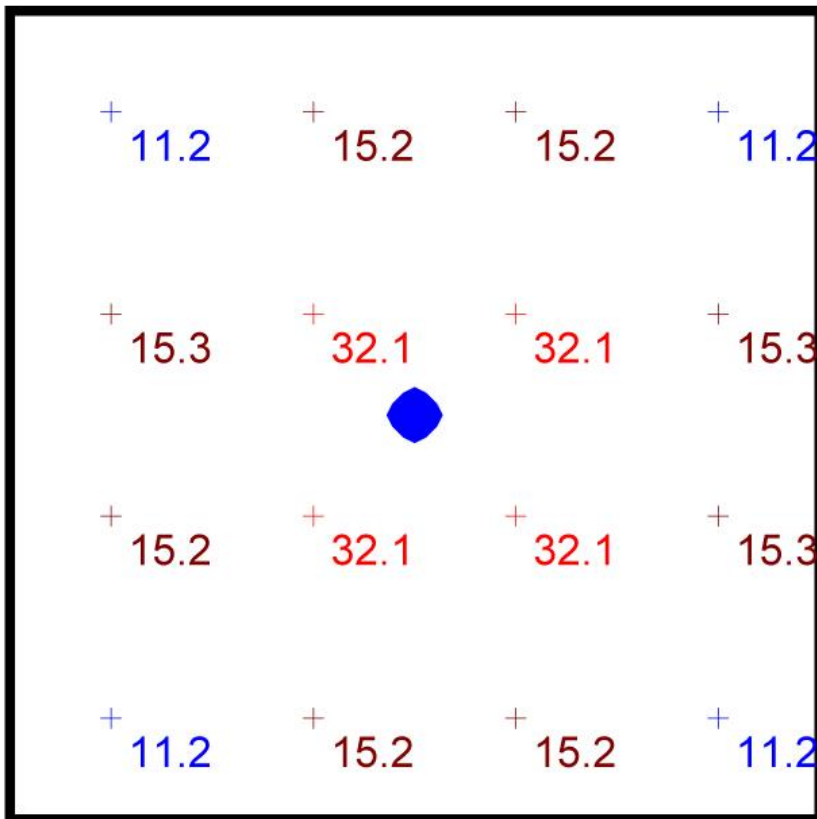

Plan View
Scale - 1" = 2ft

- 10' x 10' x 10'H space
- 80/50/20 reflectances
- bottom of fixture at 8'0" aff
- FC readings at 2.5' aff
- layout conducted using P2519 unit with HI lumen 90cri package providing 2980 delivered lumens



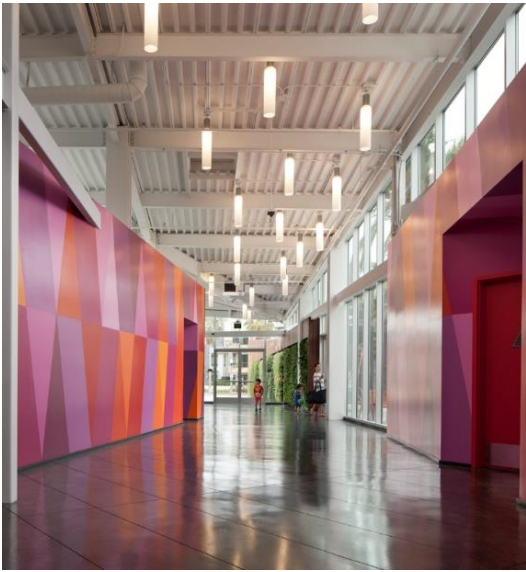

www.impactltg.com

- spec sheet and color chart
- photometric files and BIM models
- built to order in Saint Louis, MO, USA
- 4-week lead time

mere™ 5-slider

